

simpliframe™

www.simpliframe.com 1-800-511-7522

Simpliframe Small Square (8' Span)

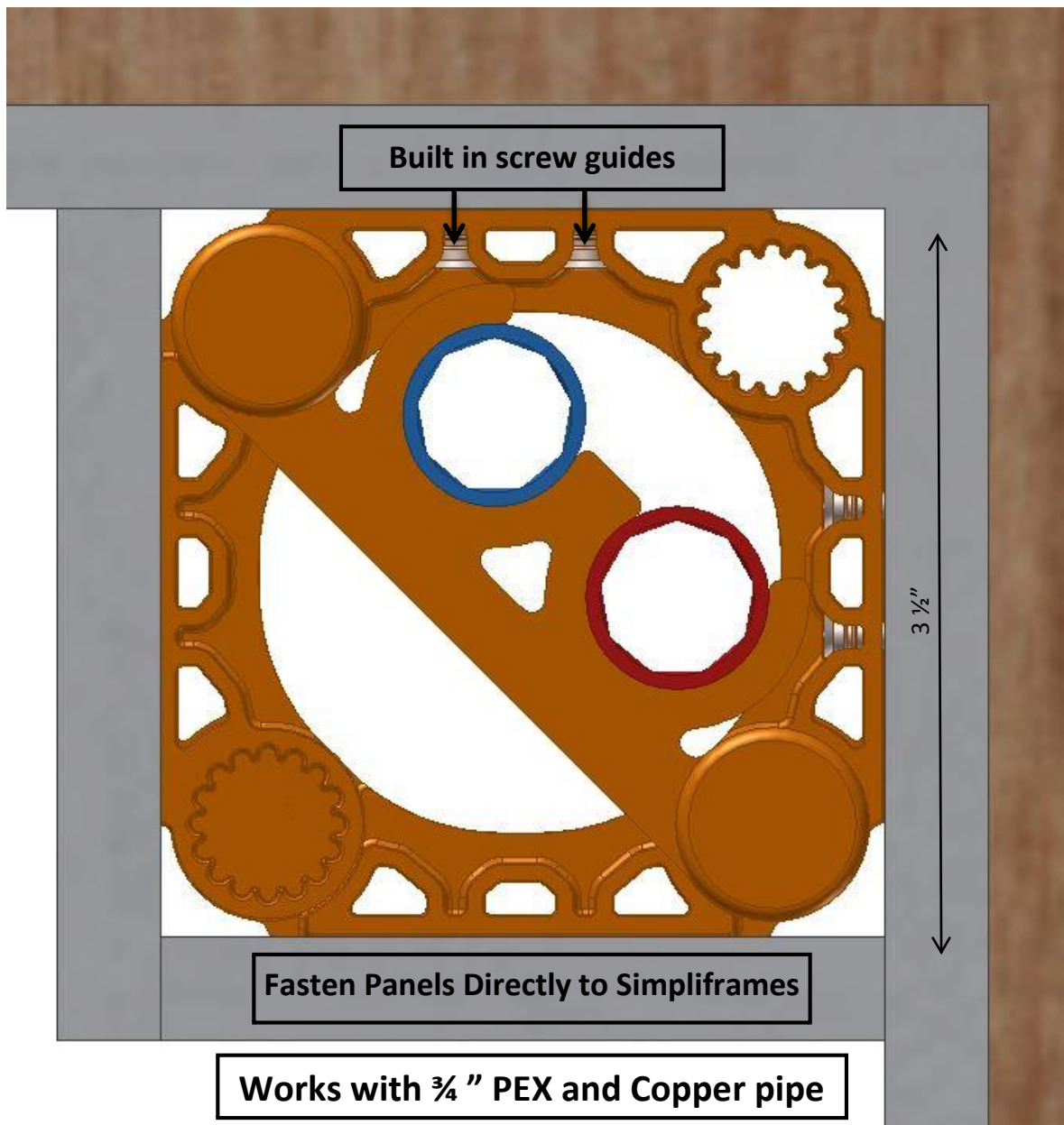

Parts

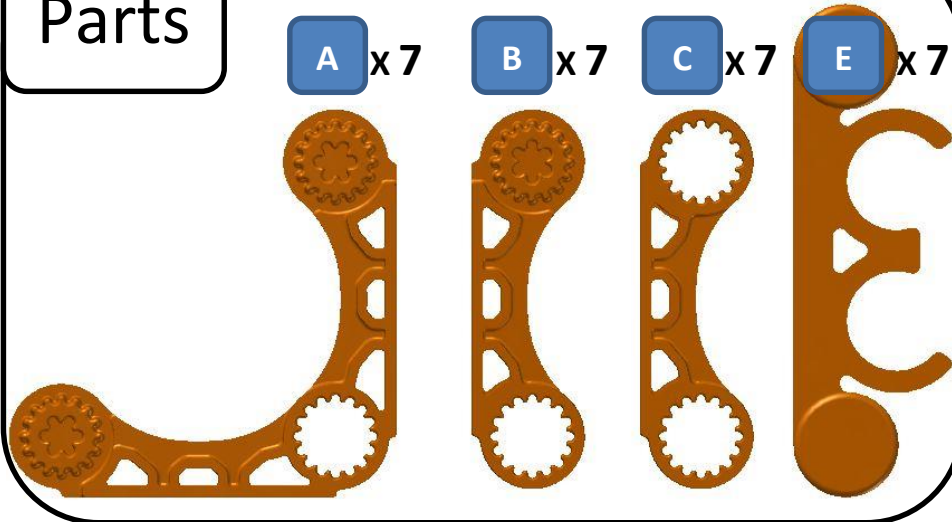

Directions

1. Fasten Part A to Wall Stud or floor joist using built in screw guides.
2. Plug Parts B, C, and E into Part A. Use a clamp to make the connection permanent.
3. Repeat steps 1 and 2 every 16" On Center.
4. Snap pipe into Part E and cover with gypsum board using maximum 1 1/4" screws.

Step 1

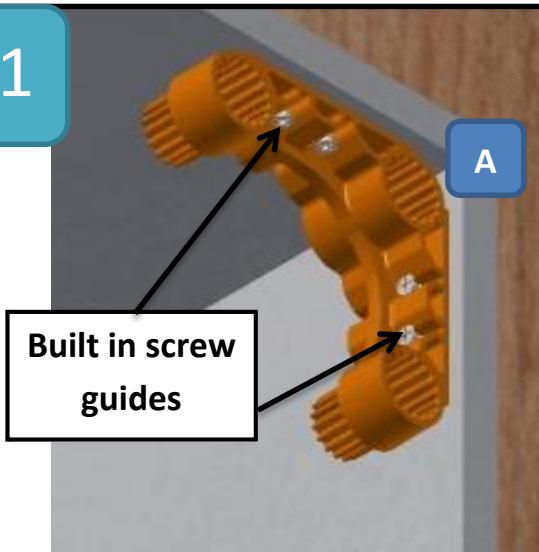

Note: For non-structural assemblies only. Must be covered by appropriate flame spread and smoke index finishes

Check out our installation videos at

www.Simpliframe.com

Patents Pending

Step 2

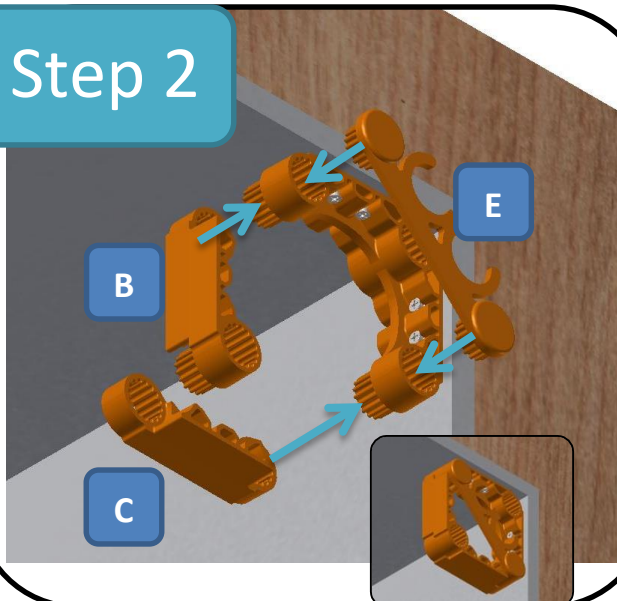

Step 3

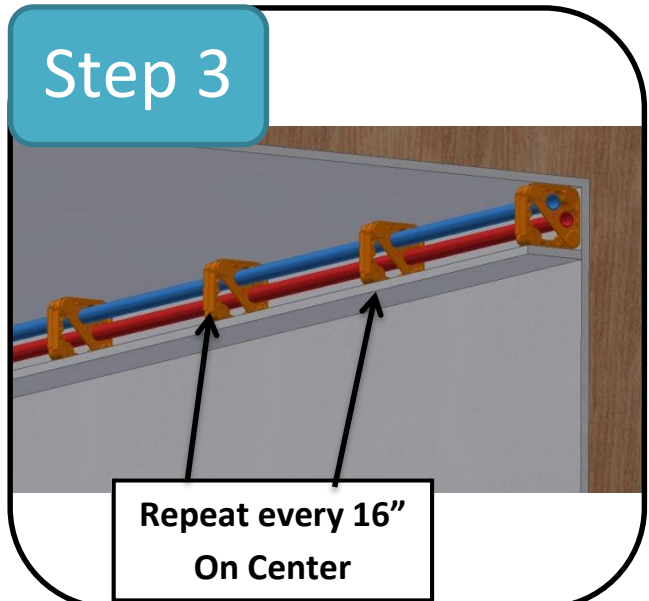

We shall not be liable for incidental and consequential damages, directly or indirectly sustained, nor for any loss caused by application of these goods not in accordance with current printed instruction or for other than the intended use. Our Liability is expressly limited to replacement of defective goods. Any claim shall be deemed waived unless made in writing to us within thirty (30) days of the date it was or reasonably should have been discovered.