

# simplif<sup>®</sup>frame

www.simplif<sup>®</sup>frame.com 1-800-511-7522

## Column Enclosure

---

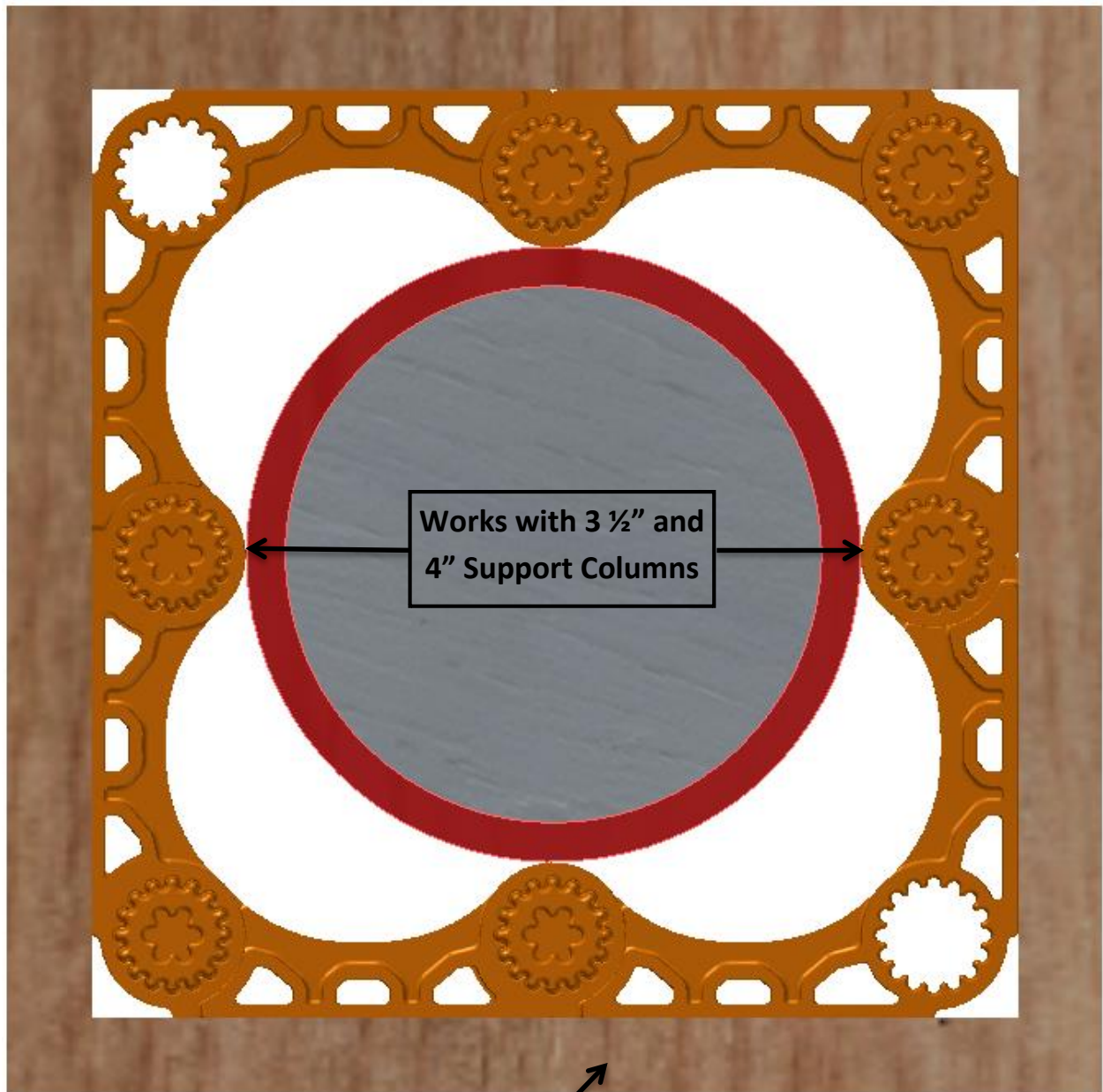

Fasten Panels Directly to Simplif<sup>®</sup>frames

## Parts

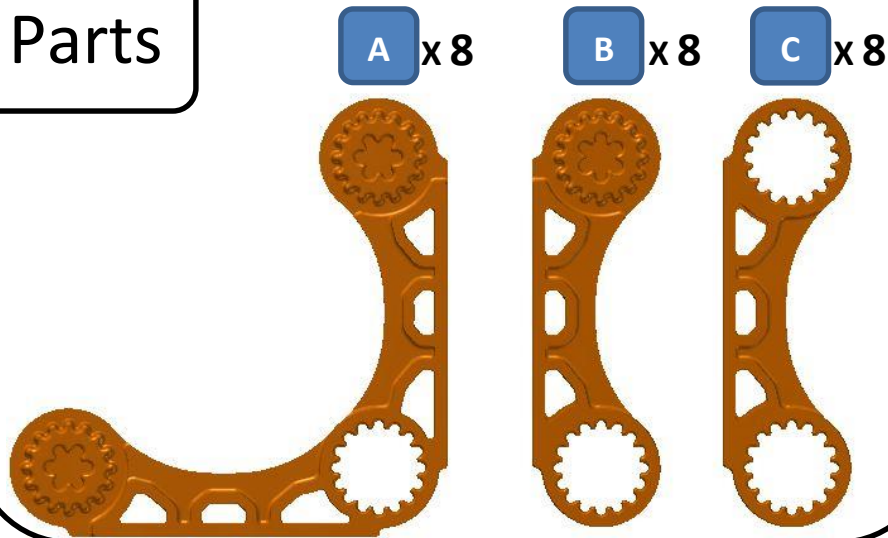

## Directions

1. Plug Parts A, B, and C together. Repeat four times. Clamp together for a permanent connection.
2. Snap the remaining Parts A, B, and C around column to hold in place (shim two sides for 3 ½" columns). Fasten these assemblies to the top, two in the middle, and bottom of column.
3. Fasten gypsum board or wood paneling to the Simpliframes and finish with trim as desired.

Note: For non-structural assemblies only. Must be covered by appropriate flame spread and smoke index finishes

Installation videos and other projects can be found at [www.Simpliframe.com](http://www.Simpliframe.com)

Patents Pending

## Step 1

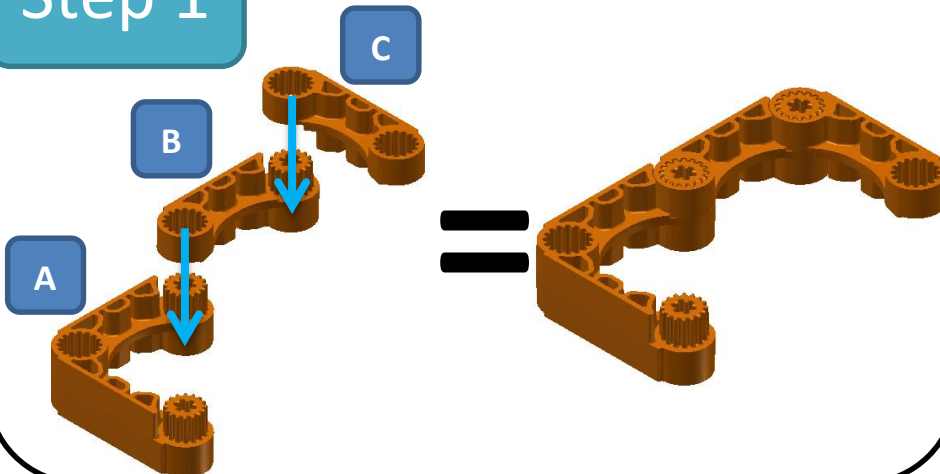

## Step 2

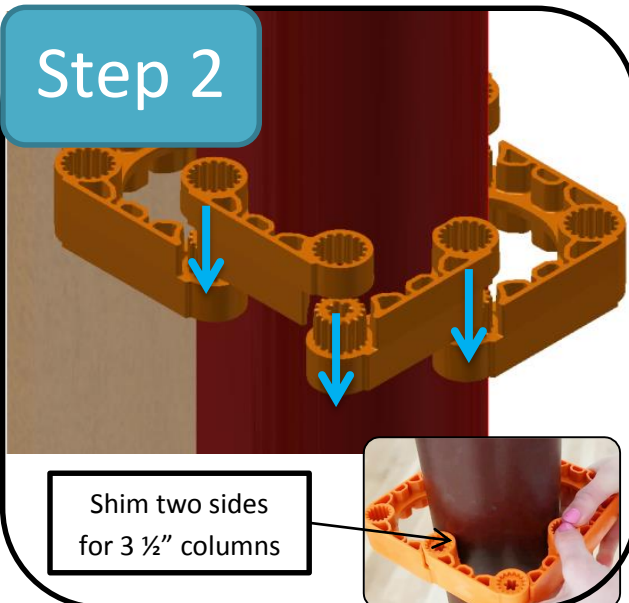

## Step 3



We shall not be liable for incidental and consequential damages, directly or indirectly sustained, nor for any loss caused by application of these goods not in accordance with current printed instruction or for other than the intended use. Our Liability is expressly limited to replacement of defective goods. Any claim shall be deemed waived unless made in writing to us within thirty (30) days of the date it was or reasonably should have been discovered.